

# BLACK+ DECKER™

20V MAX\* LITHIUM  
GARDEN CULTIVATOR

INSTRUCTION MANUAL  
CATALOG NUMBER  
LGC120

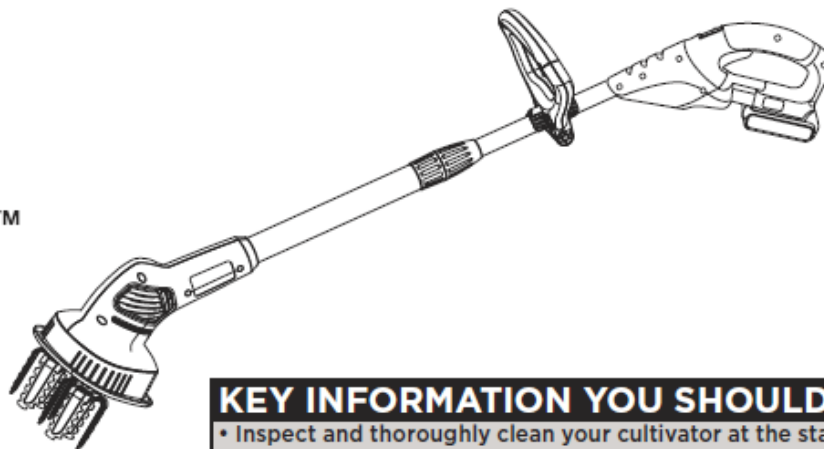

#### KEY INFORMATION YOU SHOULD KNOW:

- Inspect and thoroughly clean your cultivator at the start of each use.
- The blades on this tool are not intended to be sharp. Do not sharpen.
- Make sure area is clear of other persons or pets prior to starting operation.
- Make sure work area is clear of underground wires and pipes.

Thank you for choosing BLACK+DECKER!

**PLEASE READ BEFORE RETURNING THIS PRODUCT FOR ANY REASON.**

If you have a question or experience a problem with your BLACK+DECKER purchase, go to <http://www.blackanddecker.com/instantanswers>. If you can't find the answer or do not have access to the Internet, call 1-800-544-6986 from 8 a.m. to 5 p.m. EST Mon. - Fri. to speak with an agent. Please have the catalog number available when you call.

**SAVE THIS MANUAL FOR FUTURE REFERENCE.**

VEA EL ESPAÑOL EN LA CONTRAPORTADA. INSTRUCTIVO DE OPERACIÓN, CENTROS DE SERVICIO Y PÓLIZA DE GARANTÍA. ADVERTENCIA: LÉASE ESTE INSTRUCTIVO ANTES DE USAR EL PRODUCTO.

\*Maximum initial battery pack voltage (measured without a workload) is 20 volts. Measured under a workload, nominal voltage is 18.

To register your new product, call 1-800-544-6986 or visit [www.BlackandDecker.com/NewOwner](http://www.BlackandDecker.com/NewOwner)

## SAFETY GUIDELINES - DEFINITIONS

It is important for you to read and understand this manual. The information it contains relates to protecting YOUR SAFETY and PREVENTING PROBLEMS. The symbols below are used to help you recognize this information.

**⚠ DANGER:** Indicates an imminently hazardous situation which, if not avoided, will result in death or serious injury.

**⚠ WARNING:** Indicates a potentially hazardous situation which, if not avoided, could result in death or serious injury.

**⚠ CAUTION:** Indicates a potentially hazardous situation which, if not avoided, may result in minor or moderate injury.

**CAUTION:** Used without the safety alert symbol indicates a potentially hazardous situation which, if not avoided, may result in property damage.

## GENERAL SAFETY FOR ALL TOOLS

### **⚠ WARNING: TO REDUCE RISK OF INJURY:**

- Before any use, be sure everyone using this tool reads and understands all safety instructions and other information contained in this manual.
- Save these instructions and review frequently prior to use and in instructing others.

### **READ ALL INSTRUCTIONS**

**⚠ WARNING:** When using electric gardening appliances, basic safety precautions should always be followed to reduce risk of fire, electric shock, and personal injury:

- **ALWAYS WEAR EYE PROTECTION** – Wear safety glasses or goggles at all times when this unit is in use. Safety glasses are available at extra cost at your local BLACK+DECKER Service Center or authorized service facility. Always use face or dust mask if operation is dusty.
- **DRESS PROPERLY** – Do not wear loose clothing or jewelry. They

can be caught in moving parts. Rubber gloves and substantial rubber soled footwear are recommended when working outdoors. Don't operate the unit when barefoot or wearing open sandals. Wear long pants to protect your legs. Wear protective hair covering to contain long hair.

- **DO NOT** allow children to operate this unit.
- **MAKE SURE** that other persons and pets are at least 20 ft. away.
- **AVOID ACCIDENTALLY STARTING** – Don't carry unit with finger on trigger.
- **DON'T OVERREACH** – Keep proper footing and balance at all times.
- **AVOID DANGEROUS ENVIRONMENTAL CONDITIONS** – Do not use electric units in damp or wet locations. Don't use the unit in the rain.
- **DO NOT OPERATE** unit in gaseous or explosive atmospheres. Motors in these units normally spark, and the sparks might ignite fumes.
- **STORE IDLE APPLIANCES INDOORS** – When not in use, units should be stored indoors in a dry locked-up place out of reach of children.
- **STAY ALERT**– Watch what you are doing. Use common sense. Do not operate unit when you are tired or under the influence of alcohol, drugs, or medications.
- **KEEP HANDS AND FEET AWAY FROM WORK AREA.**
- **DO NOT CHARGE APPLIANCE IN RAIN OR IN WET LOCATIONS.**
- **THIS POWER UNIT** is intended to be correctly orientated in a vertical or floor mount position.

### **⚠ ADDITIONAL WARNINGS FOR CULTIVATORS**

- **DO NOT** use unit if switch does not turn it on or off. A unit that cannot be controlled with the switch is dangerous and must be repaired.
- **DISCONNECT** battery pack from unit before making any adjustments, changing accessories, or storing the unit. Such preventative safety measures reduce the risk of starting the unit accidentally.
- **DO NOT FORCE THE APPLIANCE** – It will do the job better and with less likelihood of a risk of injury at the rate for which it was designed. Clutch will activate if overpowered.

- **USE THE RIGHT APPLIANCE** – Do not use this unit for any job except that for which it is intended.
- ⚠ **WARNING: Some dust created by this product contains chemicals known to the State of California to cause cancer, birth defects or other reproductive harm. Some examples of these chemicals are:**
  - compounds in fertilizers
  - compounds in insecticides, herbicides and pesticides
  - arsenic and chromium from chemically treated lumber









To reduce your exposure to these chemicals, wear approved safety equipment such as dust masks that are specially designed to filter out microscopic particles.
- **DAMAGE TO APPLIANCE** – If you strike or become entangled with a foreign object, stop tool immediately, check for damage and have any damage repaired before further operation is attempted. Do not operate with a broken tine.
- **MAINTAIN APPLIANCES WITH CARE** – Keep cutting edge clean for best performance and to reduce the risk of injury. Follow instructions for lubricating and changing accessories. Keep handles dry, clean, and free from oil and grease.
- **CHECK DAMAGED PARTS** – Before further use of the unit, a shroud or other part that is damaged should be carefully checked to determine that it will operate properly and perform its intended function. Check for alignment of moving parts, binding of moving parts, breakage of parts, mounting, and any other condition that may affect its operation. Any part that is damaged should be properly repaired or replaced by an authorized service center unless otherwise indicated elsewhere in this manual.
- **KEEP SHROUD IN PLACE AND IN WORKING ORDER.**
- **BEFORE STARTING GARDEN CULTIVATOR**, check the soil and remove any large stones, twigs and so forth. Keep checking to make sure the area is clear as you work.
- **IF YOU ENCOUNTER AN OBSTRUCTION** during work despite all of these precautions, turn off the Cultivator. Remove battery prior to attempting to remove the obstruction.
- **Keep tine area clean.**
- ⚠ **WARNING: Oscillating tines.** Keep at a safe distance.

## ⚠ BATTERY RELATED WARNINGS

- **A BATTERY OPERATED UNIT** with integral batteries or a separate battery pack must be recharged only with the specified charger for the battery. A charger that may be suitable for one type of battery may create a risk of fire when used with another battery.
- **USE BATTERY OPERATED UNIT ONLY** with specifically designated battery pack. Use of any other batteries may create a risk of fire.
- **DO NOT USE OR CHARGE** battery in rain.
- **USE ONLY** the supplied charger.
- **REMOVE BATTERY** before servicing, cleaning or removing material from the cultivator. Remove battery from your cultivator and carry by the front handle when not in use.
- **EXERCISE CARE** in handling batteries in order not to short the battery with conducting materials such as rings, bracelets and keys. The battery or conductor may overheat and cause burns.
- **DO NOT OPEN OR MUTILATE** the batteries. Released electrolyte is corrosive and may cause damage to the eyes or skin. It may be toxic if swallowed.

## Symbols

The label on your tool may include the following symbols. The symbols and their definitions are as follows:

|   |  |   |   |
|---|--|---|---|
| V .....   | volts                                    | A.....  | amperes                                 |
| Hz .....  | hertz                                    | W.....  | watts                                   |
| min.....  | minutes                                  | ~ or AC.....  | alternating current                     |
|   | or DC direct current                     | n <sub>0</sub> .....  | no load speed                           |
|  | Class I Construction (grounded)          |  | earthing terminal                       |
|  | Class II Construction (double insulated) | ⚠ .....   | safety alert symbol                     |
|  | .....                                    | .../min or rpm.....   | revolutions or reciprocation per minute |
|  | .....                                    |   |   |
|  | .....                                    |   |   |
|  | .....                                    |   |   |

## IMPORTANT SAFETY INSTRUCTIONS FOR BATTERY CHARGERS

**SAVE THESE INSTRUCTIONS:** This manual contains important safety instructions for battery chargers.

- Before using charger, read all instructions and cautionary markings on charger, battery pack, and product using battery pack.

**⚠WARNING: Shock hazard.** Do not allow any liquid to get inside charger.

**⚠CAUTION: Burn hazard.** To reduce the risk of injury, charge only designated **BLACK+DECKER** batteries. Other types of batteries may burst causing personal injury and damage.

**⚠CAUTION:** Under certain conditions, with the charger plugged in to the power supply, the charger can be shorted by foreign material. Foreign materials of a conductive nature such as, but not limited to, steel wool, aluminum foil, or any buildup of metallic particles should be kept away from charger cavities. Always unplug the charger from the power supply when there is no battery pack in the cavity. Unplug charger before attempting to clean.

- The charger supplied with this product is intended to be plugged in such that it is correctly orientated in a vertical or floor mount position.
- DO NOT attempt to charge the battery pack with any chargers other than the ones in this manual. *The charger and battery pack are specifically designed to work together.*
- These chargers are not intended for any uses other than charging designated **BLACK+DECKER** rechargeable batteries. *Any other uses may result in risk of fire, electric shock or electrocution.*
- Do not expose charger to rain or snow.
- Pull by plug rather than cord when disconnecting charger. *This will reduce risk of damage to electric plug and cord.*
- Make sure that cord is located so that it will not be stepped on, tripped over, or otherwise subjected to damage or stress.
- Do not use an extension cord unless it is absolutely necessary.

*Use of improper extension cord could result in risk of fire, electric shock, or electrocution.*

- An extension cord must have adequate wire size (AWG or American Wire Gauge) for safety. *The smaller the gauge number of the wire, the greater the capacity of the cable, that is 16 gauge has more capacity than 18 gauge. When using more than one extension to make up the total length, be sure each individual extension contains at least the minimum wire size.*

### Recommended Minimum Wire Size for Extension Cords

| Volts         | Minimum Gauge for Cord Sets  |                     |                 |         |
|---------------|------------------------------|---------------------|-----------------|---------|
|               | Total Length of Cord in Feet |                     |                 |         |
| 120V          | 0-25                         | 26-50               | 51-100          | 101-150 |
| 240V          | 0-50                         | 51-100              | 101-200         | 201-300 |
| Ampere Rating |                              |                     |                 |         |
| More Than     |                              | Not more Than       |                 |         |
| Than          |                              | American Wire Gauge |                 |         |
| 0 - 6         | 18                           | 16                  | 16              | 14      |
| 6 - 10        | 18                           | 16                  | 14              | 12      |
| 10 - 12       | 16                           | 16                  | 14              | 12      |
| 12 - 16       | 14                           | 12                  | Not Recommended |         |

- Do not place any object on top of charger or place the charger on a soft surface that might block the ventilation slots and result in excessive internal heat. Place the charger in a position away from any heat source. *The charger is ventilated through slots in the top and the bottom of the housing.*
- Do not mount charger on wall or permanently affix charger to any surface. *The charger is intended to use on a flat, stable surface (i.e., table top, bench top).*
- Do not operate charger with damaged cord or plug — have them replaced immediately.
- Do not operate charger if it has received a sharp blow, been dropped, or otherwise damaged in any way. *Take it to an authorized service center.*
- Do not disassemble charger; take it to an authorized service center when service or repair is required. *Incorrect reassembly may result in a risk of electric shock, electrocution or fire.*

- **Disconnect the charger from the outlet before attempting any cleaning.** *This will reduce the risk of electric shock. Removing the battery pack will not reduce this risk.*
- **NEVER attempt to connect 2 chargers together.**
- **The charger is designed to operate on standard household electrical power (120 Volts). Do not attempt to use it on any other voltage.**

## SAVE THESE INSTRUCTIONS

### IMPORTANT SAFETY WARNINGS FOR BATTERY PACKS

**⚠WARNING:** *For safe operation, read this manual and manuals originally supplied with tool before using the charger.*

The battery pack is not fully charged out of the carton. Before using the battery pack and charger, read the safety instructions below.

Then follow charging procedures outlined.

### READ ALL INSTRUCTIONS

- **Do not incinerate the battery pack even if it is severely damaged or is completely worn out.** *The battery pack can explode in a fire. Toxic fumes and materials are created when battery packs are burned.*
- **Do not charge or use battery in explosive atmospheres, such as in the presence of flammable liquids, gases or dust.** *Inserting or removing the battery from the charger may ignite the dust or fumes.*
- **If battery contents come into contact with the skin, immediately wash area with mild soap and water.** *If battery liquid gets into the eye, rinse water over the open eye for 15 minutes or until irritation ceases. If medical attention is needed, the battery electrolyte for Li-ion batteries is composed of a mixture of liquid organic carbonates and lithium salts.*
- **Contents of opened battery cells may cause respiratory irritation.** *Provide fresh air. If symptoms persist, seek medical attention.*

**⚠WARNING: Burn hazard.** *Battery liquid may be flammable if exposed to spark or flame.*

- *Charge the battery packs only in BLACK+DECKER chargers.*
- **DO NOT splash or immerse in water or other liquids.** *This may cause premature cell failure.*
- **Do not store or use the tool and battery pack in locations where the temperature may reach or exceed 105°F (40°C) (such as outside sheds or metal buildings in summer).**

**⚠WARNING:** *Never attempt to open the battery pack for any reason. If battery pack case is cracked or damaged, do not insert into charger. Do not crush, drop or damage battery pack. Do not use a battery pack or charger that has received a sharp blow, been dropped, run over or damaged in any way (i.e., pierced with a nail, hit with a hammer, stepped on). Damaged battery packs should be returned to service center for recycling.*

**⚠WARNING: Fire hazard. Do not store or carry battery so that metal objects can contact exposed battery terminals.** *For example, do not place battery in aprons, pockets, tool boxes, product kit boxes, drawers, etc., with loose nails, screws, keys, etc. Transporting batteries can possibly cause fires if the battery terminals inadvertently come in contact with conductive materials such as keys, coins, hand tools and the like. The US Department of Transportation Hazardous Material Regulations (HMR) actually prohibit transporting batteries in commerce or on airplanes (i.e., packed in suitcases and carry-on luggage) UNLESS they are properly protected from short circuits. So when transporting individual batteries, make sure that the battery terminals are protected and well insulated from materials that could contact them and cause a short circuit. NOTE: LI-ION batteries should not be put in checked baggage.*

### STORAGE RECOMMENDATIONS

1. The best storage place is one that is cool and dry away from direct sunlight and excess heat or cold.
2. Long storage will not harm the battery pack or charger.

## COMPONENTS

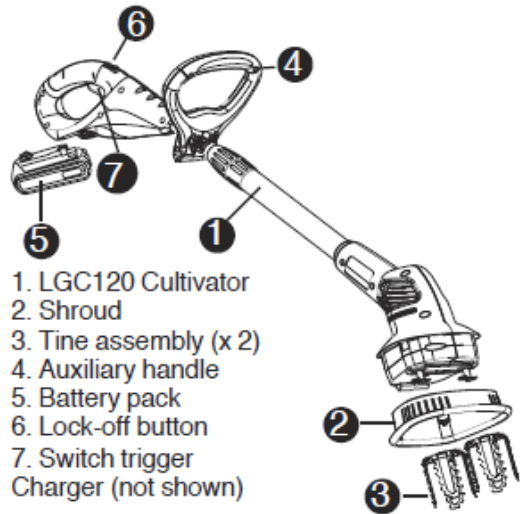

## CHARGING PROCEDURE

The standard charger provided will charge a fully depleted battery in about 4 hours.

1. Plug the charger into an appropriate outlet before inserting the battery pack.
2. Insert the battery pack into the charger as shown in **figure A**.
3. The green LED will flash indicating that the battery is being charged.
4. The completion of charge is indicated by the green LED remaining on continuously. The pack is fully charged and may be used at this time or left on the charger.

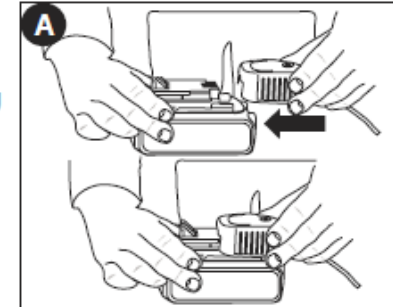

**Recharge discharged batteries as soon as possible after use or battery life may be greatly diminished.** It is recommended that the batteries be recharged after each use.

### LEAVING THE BATTERY IN THE CHARGER

The charger and battery pack can be left connected with the green LED glowing indefinitely. The charger will keep the battery pack fresh and fully charged.

### IMPORTANT CHARGING NOTES

1. Longest life and best performance can be obtained if the battery pack is charged when the air temperature is between 60°F and 80°F (16°- 27°C). DO NOT charge the battery pack in an air temperature below +40°F (+4.5°C), or above +105°F (+40.5°C). This is important and will prevent serious damage to the battery pack.
2. The charger and battery pack may become warm to touch while charging. This is a normal condition, and does not indicate a problem. To facilitate the cooling of the battery pack after use, avoid placing the charger or battery pack in a warm environment such as in a metal shed, or an uninsulated trailer.

3. If the battery pack does not charge properly:
  - a. Check current at receptacle by plugging in a lamp or other appliance
  - b. Check to see if receptacle is connected to a light switch which turns power off when you turn out the lights.
  - c. Move charger and battery pack to a location where the surrounding air temperature is approximately 60°F and 80°F (16°- 27°C)
  - d. If charging problems persist, take the tool, battery pack and charger to your local service center.
4. The battery pack should be recharged when it fails to produce sufficient power on jobs which were easily done previously. DO NOT CONTINUE to use under these conditions. Follow the charging procedure. You may also charge a partially used pack whenever you desire with no adverse affect on the battery pack.
5. Foreign materials of a conductive nature such as, but not limited to, steel wool, aluminum foil, or any buildup of metallic particles should be kept away from charger cavities. Always unplug the charger from the power supply when there is no battery pack in the cavity. Unplug charger before attempting to clean.
6. Do not freeze or immerse charger in water or any other liquid.

**⚠WARNING: Shock hazard.** Do not allow any liquid to get inside charger. *Never attempt to open the battery pack for any reason. If the plastic housing of the battery pack breaks or cracks, return to a service center for recycling.*

## INSTALLING / REMOVING BATTERY PACK

**⚠WARNING:** *Make certain the lock-off button is engaged to prevent switch actuation before removing or installing battery.*

**TO INSTALL BATTERY PACK:** Insert battery pack into tool until an audible click is heard (**figure B**).

**TO REMOVE BATTERY PACK:** Depress the battery release

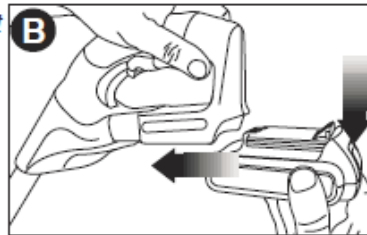

button in the back of the battery pack and pull battery pack out of tool (**figure B**).

## ASSEMBLY

### AUXILIARY HANDLE ASSEMBLY (FIG. C)

- Position handle on upper tube to desired height.
- Ensure locking block (8) is aligned with groove in tube.
- Assemble and tighten bolt (9).

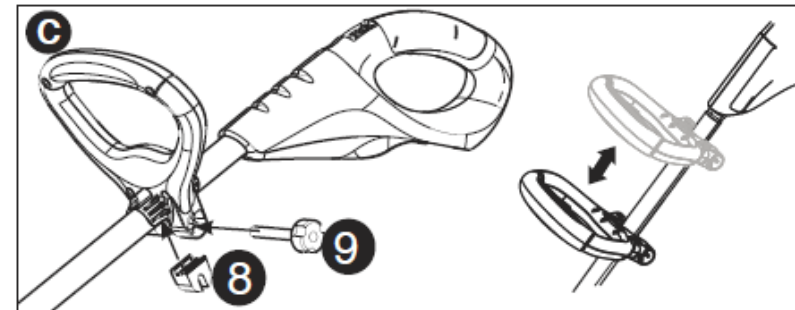

### POLE EXTENSION (FIG. D)

- Loosen collar (10).
- Extend poles to desired length.
- Tighten collar.

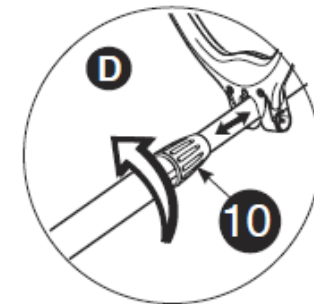

### SHROUD ASSEMBLY (FIG. E)

- Position the open center of the shroud (11) over the lower housing from the bottom (near output shaft).
- Align snap tabs to housing. Apply even pressure to shroud until snap sound is heard.
- Ensure all snap features are engaged correctly.

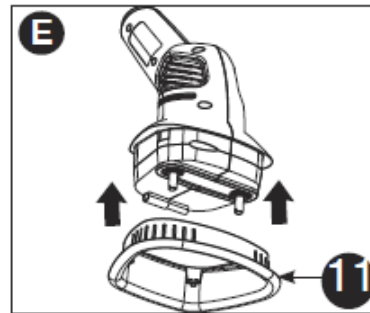

**⚠WARNING: NEVER OPERATE TOOL WITHOUT SHROUD FIRMLY IN PLACE.**

### TINE ASSEMBLY (FIG. F)

**⚠WARNING: Release trigger, allow tines to come to a complete stop, and remove battery.**

- Place tine (12) on shaft (13), making sure flat in hole of tine is aligned with flat on shaft. Be sure to push tine completely onto shaft.
- Insert straight end of pin (14) into shaft hole. Push in pin completely until the looped end bottoms out against the shaft.
- Repeat for other tine. For tine removal reverse the process.

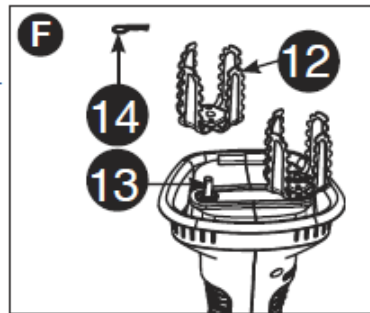

### OPERATION (FIG. G, H)

**⚠WARNING: Make sure that other persons and pets are at least 20 feet away.**

- Hold tool as shown in figure G.
- Lift unit out of soil.
- Slide lock off button (15) (Fig. H).
- Pull switch trigger (16) (Fig. H)

For the first cultivating each season, it is best to move slowly because dirt is packed down. Subsequent cultivating will be completed more rapidly. Do not attempt to cultivate when the soil is wet - for electrical safety and to prevent clogging of the tines. If you must cultivate under conditions that cause the tines to become clogged, release trigger, wait for tines to come to complete stop! REMOVE BATTERY!

Remove clogged material with a stick or screwdriver. To continue to operate the tool in a clogged condition will seriously overload the motor. **NOTE:** This unit is equipped with a built in clutching mechanism used to prevent permanent damage to the unit due to an obstruction in the tines or overloaded working conditions. If the clutch is engaged, the unit will make a loud clicking sound. This noise will persist until the obstruction or overload condition is removed.

Remove battery prior to attempting to remove obstructions from tines. The clutch mechanism is not adjustable by the user.

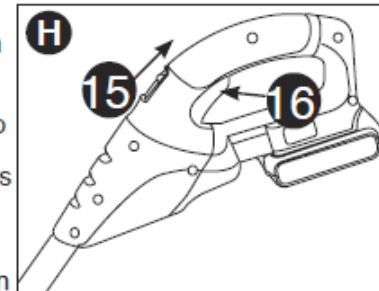



**⚠CAUTION:** Do not attempt to unclog the tines by dropping or tapping the tool on the ground. This can damage the unit.

## STORAGE

Remove and clean any debris from the outside of the cultivator and inside of shroud before storage. See **MAINTENANCE** section.

**⚠CAUTION: DO NOT HANG ON THE SWITCH TRIGGER**

**Note:** Do not store the tool on or adjacent to fertilizers or chemicals. Such storage can cause rapid corrosion.

## PREVENTING CORROSION

**⚠WARNING:** Wear proper gloves and eye protection when cleaning tool.

Fertilizers and other garden chemicals contain agents that greatly accelerate the corrosion of metals. If you use the tool in areas where fertilizers or chemicals have been used, the tool should be cleaned immediately afterwards. Wipe all exposed parts with a damp cloth. You may lubricate only metal parts with a light petroleum based oil. When cleaning, **DO NOT** immerse tool in water or spray it with a hose.

## ACCESSORIES

Replacement tines (RT400) for use with your tool are available from your local dealer or authorized service center. If you need assistance regarding accessories, please call: 1-800-544-6986.

**⚠WARNING:** The use of any accessory not recommended for use with this tool could be hazardous.

## MAINTENANCE

Use only mild soap and damp cloth to clean the tool. Never let any liquid get inside the tool; never immerse any part of the tool into a liquid. **IMPORTANT:** To assure product **SAFETY** and **RELIABILITY**, repairs, maintenance and adjustment (other than those listed in this manual) should be performed by authorized service centers or other qualified service organizations, always using identical replacement parts.

## TROUBLESHOOTING

| <u>Problem</u>   | <u>Possible Cause</u>  | <u>Possible Solution</u>   |
|--|--|--|
| <ul style="list-style-type: none"><li>• Tool will not start.</li></ul>     | <ul style="list-style-type: none"><li>• Battery not installed properly.</li><li>• Battery not charged.</li><li>• Lock-out button not actuated.</li></ul> | <ul style="list-style-type: none"><li>• Check battery installation.</li><li>• Check battery charging requirements.</li><li>• Pull back on lock button/actuate trigger.</li></ul> |
| <ul style="list-style-type: none"><li>• Battery will not charge.</li></ul> | <ul style="list-style-type: none"><li>• Battery not inserted into charger.</li></ul>   | <ul style="list-style-type: none"><li>• Insert battery into charger until green LED appears. Charge up to 8 hours if battery totally drained.</li></ul>                          |

Fertilizers and other garden chemicals contain agents which greatly accelerate the corrosion of metals. Do not store the tool on or adjacent to fertilizers or chemicals.

With the battery removed, use only mild soap and a damp cloth to clean the tool. Never let any liquid get inside the tool; never immerse any part of the tool into a liquid.

For assistance with your product, visit our website [www.blackanddecker.com](http://www.blackanddecker.com) for the location of the service center nearest you or call the BLACK+DECKER help line at 1-800-544-6986.

## SERVICE INFORMATION

All BLACK+DECKER Service Centers are staffed with trained personnel to provide customers with efficient and reliable power tool service. Whether you need technical advice, repair, or genuine factory replacement parts, contact the BLACK+DECKER location nearest you. To find your local service location, call: **1-800-544-6986** or visit [www.blackanddecker.com](http://www.blackanddecker.com).

### THE RBRC™ SEAL

The RBRC™ (Rechargeable Battery Recycling Corporation) Seal on the LI-ION battery (or battery pack) indicates that the costs to recycle the battery (or battery pack) at the end of its useful life have already been paid by **BLACK+DECKER**. RBRC™ in cooperation with **BLACK+DECKER** and other battery users, has established programs in the United States to facilitate the collection of spent LI-ION batteries. Help protect our environment and conserve natural resources by returning the spent LI-ION battery to an authorized **BLACK+DECKER** service center or to your local retailer for recycling. You may also contact your local recycling center for information on where to drop off the spent battery. RBRC™ is a registered trademark of the *Rechargeable Battery Recycling Corporation*. All BLACK+DECKER Service Centers are staffed with trained personnel to provide customers with efficient and reliable power tool service. Whether you need technical advice, repair, or genuine factory replacement parts, contact the BLACK+DECKER location nearest you. To find your local service location, call: **1-800-544-6986** or visit [www.blackanddecker.com](http://www.blackanddecker.com).



This Class B digital apparatus complies with Canadian ICES-003.

This device complies with part 15 of the FCC rules. Operation is subject to the following two conditions: (1) This device may not cause harmful interference, and (2) this device must accept any interference received, including interference that may cause undesired operation.

**NOTE:** This equipment has been tested and found to comply with the limits for a Class B digital device, pursuant to Part 15 of the FCC

Rules. These limits are designed to provide reasonable protection against harmful interference in a residential installation. This equipment generates, uses and can radiate radio frequency energy and, if not installed and used in accordance with the instructions, may cause harmful interference to radio communications. However, there is no guarantee that interference will not occur in a particular installation.

If this equipment does cause harmful interference to radio or television reception, which can be determined by turning the equipment off and on, the user is encouraged to try to correct the interference by one or more of the following measures:

- Reorient or relocate the receiving antenna.
- Increase the separation between the equipment and receiver.
- Connect the equipment into an outlet on a circuit different from that to which the receiver is connected.
- Consult the dealer or an experienced radio/TV technician for help.

Changes or modifications to this unit not expressly approved by the party responsible for compliance could void the user's authority to operate the equipment. This Class B digital apparatus complies with Canadian ICES-003.

## TWO-YEAR LIMITED WARRANTY

Black & Decker (U.S.) Inc. warrants this product to be free from defects in material or workmanship for a period of two (2) years following the date of purchase, provided that the product is used in a home environment. This limited warranty does not cover failures due to abuse, accidental damage or when repairs have been made or attempted by anyone other than BLACK+DECKER and its Authorized Service Centers. A defective product meeting the warranty conditions set forth herein will be replaced or repaired at no charge in either of two ways:

The first, which will result in exchanges only, is to return the product to the retailer from whom it was purchased (provided that the store is a participating retailer). Returns should be made within the time period of the retailer's policy for exchanges. Proof of purchase may be required. Please check with the retailer for its specific return policy regarding time limits for returns or exchanges.

The second option is to take or send the product (prepaid) to a BLACK+DECKER owned or authorized Service Center for repair or replacement at BLACK+DECKER's option. Proof of purchase may be required. BLACK+DECKER owned and authorized service centers online at [www.blackanddecker.com](http://www.blackanddecker.com).

This warranty does not apply to accessories. This warranty gives you specific legal rights and you may have other rights which vary from state to state. Should you have any questions, contact the manager of your nearest BLACK+DECKER Service Center. This product is not intended for commercial use, and accordingly, such commercial use of this product will void this warranty. All other guarantees, express or implied, are hereby disclaimed.

**LATIN AMERICA:** This warranty does not apply to products sold in Latin America. For products sold in Latin America, check country specific warranty information contained in the packaging, call the local company or see the website for such information.

Imported by  
Black & Decker (U.S.) Inc.,  
701 E. Joppa Rd.  
Towson, MD 21286 U.S.A.

