



## SERVICE PARTS LIST

BULLETIN NO.  
54-06-2415

SPECIFY CATALOG NO. AND SERIAL NO. WHEN ORDERING PARTS				REVISED BULLETIN	DATE
12 VOLT 3/8" RAD DRILL					Aug. 2009
CATALOG NO.	2415-20	STARTING SERIAL NO.	C23A	WIRING INSTRUCTION SEE REVERSE SIDE	

**EXAMPLE:**  
00 0  
Component Parts (Small #) Are Included  
When Ordering The Assembly (Large #).

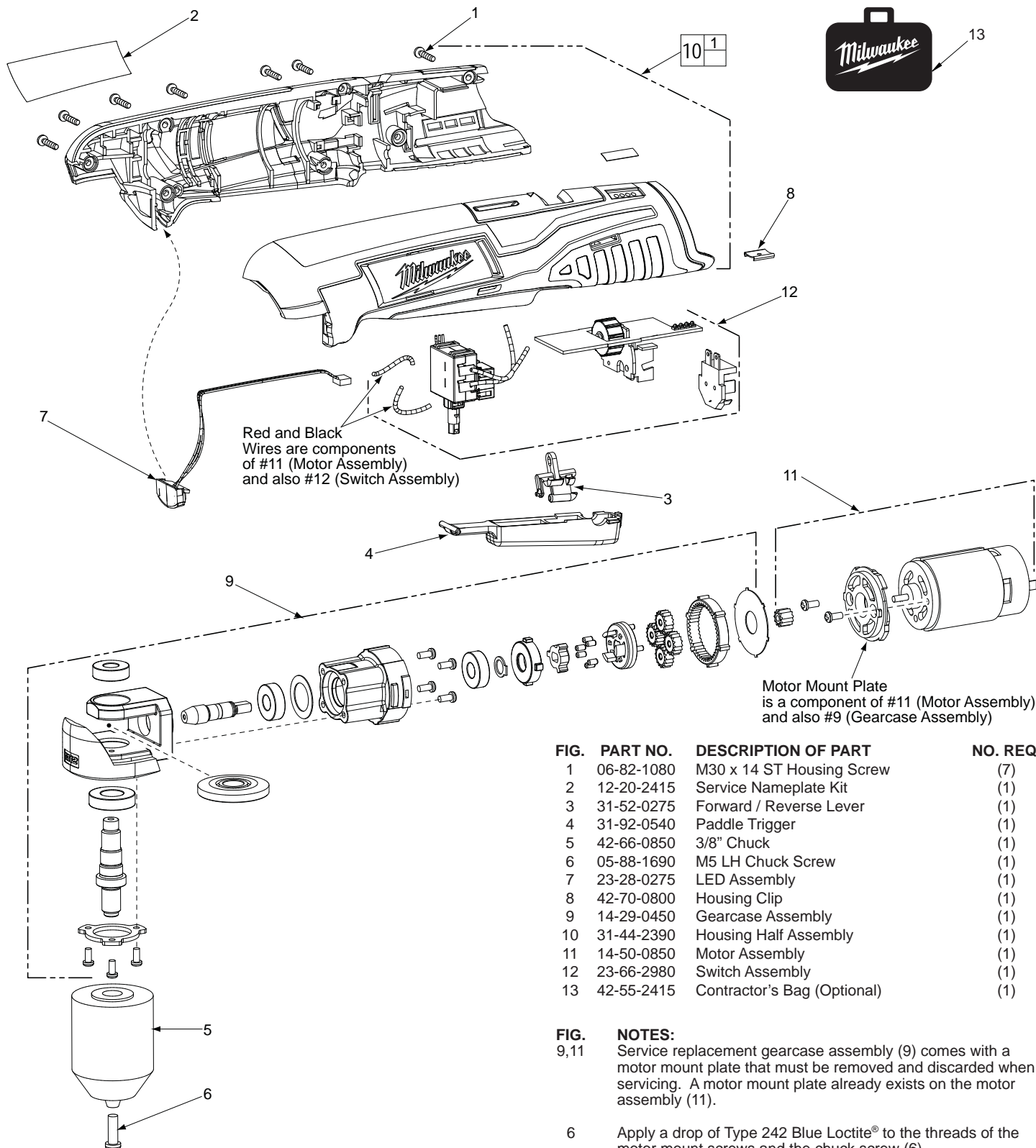
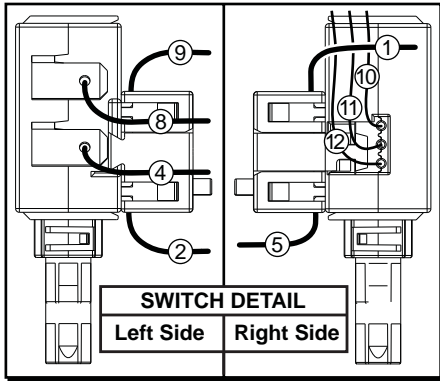
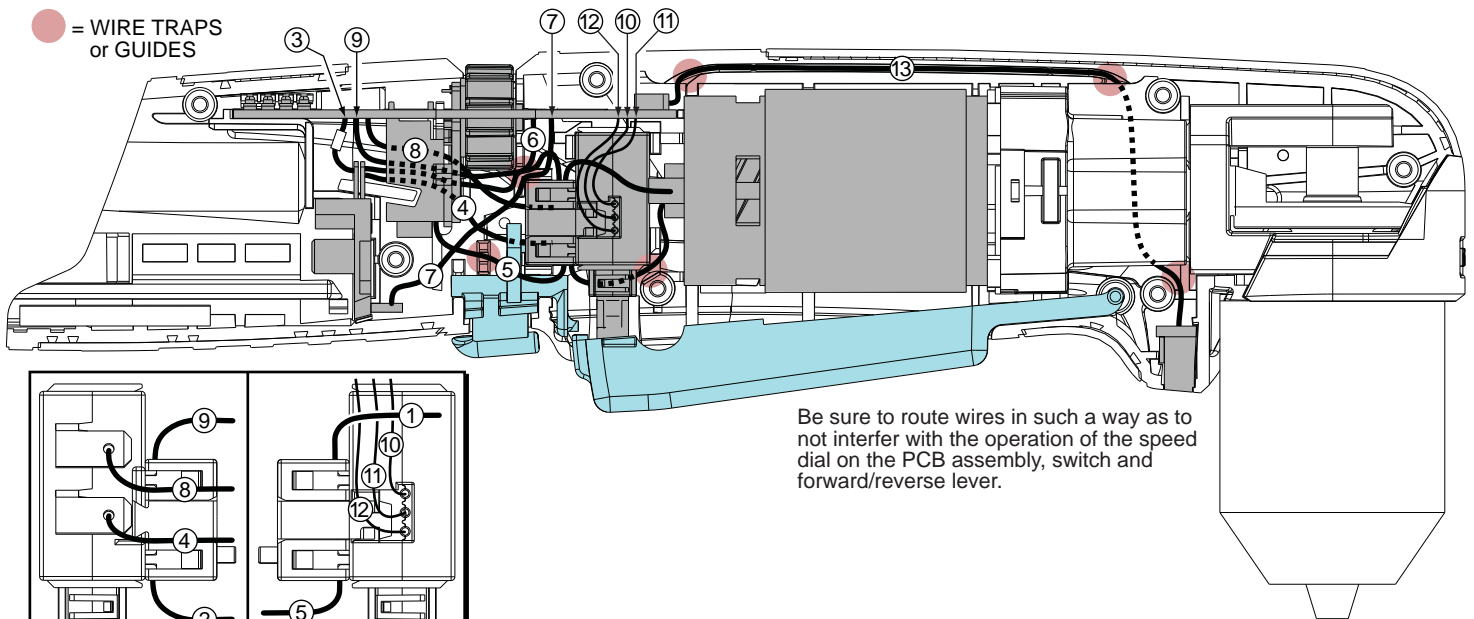

FIG.	PART NO.	DESCRIPTION OF PART	NO. REQ.
	1	06-82-1080 M30 x 14 ST Housing Screw	(7)
	2	12-20-2415 Service Nameplate Kit	(1)
	3	31-52-0275 Forward / Reverse Lever	(1)
	4	31-92-0540 Paddle Trigger	(1)
	5	42-66-0850 3/8" Chuck	(1)
	6	05-88-1690 M5 LH Chuck Screw	(1)
	7	23-28-0275 LED Assembly	(1)
	8	42-70-0800 Housing Clip	(1)
	9	14-29-0450 Gearcase Assembly	(1)
	10	31-44-2390 Housing Half Assembly	(1)
	11	14-50-0850 Motor Assembly	(1)
	12	23-66-2980 Switch Assembly	(1)
	13	42-55-2415 Contractor's Bag (Optional)	(1)

**FIG. 9,11 NOTES:**  
Service replacement gearcase assembly (9) comes with a motor mount plate that must be removed and discarded when servicing. A motor mount plate already exists on the motor assembly (11).

6 Apply a drop of Type 242 Blue Loctite® to the threads of the motor mount screws and the chuck screw (6).



**TERMINAL BLOCK ASSY.**

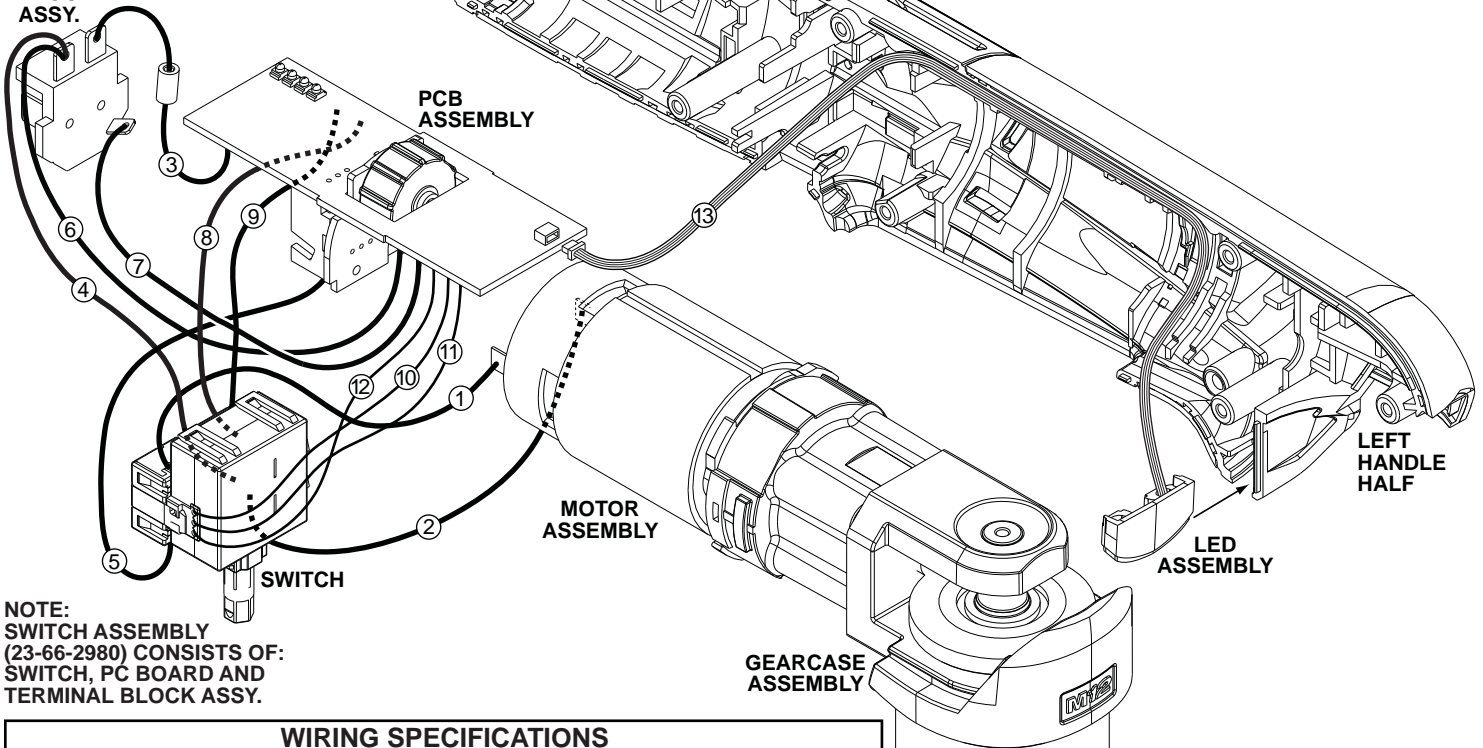

**NOTE:**  
SWITCH ASSEMBLY (23-66-2980) CONSISTS OF: SWITCH, PC BOARD AND TERMINAL BLOCK ASSY.

### WIRING SPECIFICATIONS

Wire No.	Wire Color	Origin or Gauge	Length	Terminals, Connectors and 1 or 2 End Wire Preparation
1	Black	Motor Assy.	-----	Connect from Motor (pos. terminal) to Switch.
2	Red	Motor Assy.	-----	Connect from Motor (neg. terminal) to Switch.
3	Black	Switch Assy.	-----	Attached to the PC Board and Terminal Block.
4	Red	Switch Assy.	-----	Attached to the Switch and Terminal Block.
5	White	Switch Assy.	-----	Attached to the Switch and the PC Board.
6	Red	Switch Assy.	-----	Attached to the PC Board and Terminal Block.
7	White	Switch Assy.	-----	Attached to the PC Board and Terminal Block.
8	Black	Switch Assy.	-----	Attached to the Switch and the PC Board.
9	Red	Switch Assy.	-----	Attached to the Switch and the PC Board.
10	Yellow	Switch Assy.	-----	Attached to the Switch and the PC Board.
11	Blue	Switch Assy.	-----	Attached to the Switch and the PC Board.
12	Black	Switch Assy.	-----	Attached to the Switch and the PC Board.
13	-----	LED Assy.	-----	Attach connector end of 4 wire ribbon to PC Board.