



TRIMMER/ EDGER INSTRUCTION MANUAL

Catalog Number ST4500

Thank you for choosing Black & Decker! Go to www.BlackandDecker.com/NewOwner to register your new product.

PLEASE READ BEFORE RETURNING THIS PRODUCT FOR ANY REASON:

If you have a question or experience a problem

with your Black & Decker purchase, go to

[HTTP://WWW.BLACKANDECKER.COM/INSTANTANSWERS](http://WWW.BLACKANDECKER.COM/INSTANTANSWERS)

for instant answers 24 hours a day.

If you can't find the answer or do not have access to the internet, call 1-800-544-6986 from 8 a.m. to 5 p.m. EST Mon. -- Fri. to speak with an agent. Please have the catalog number available when you call.

SAVE THIS MANUAL FOR FUTURE REFERENCE.

VEA EL ESPAÑOL EN LA CONTRAPORTADA.

POUR LE FRANÇAIS, VOIR LA COUVERTURE ARRIÈRE.

INSTRUCTIVO DE OPERACIÓN, CENTROS DE SERVICIO Y

POLIZA DE GARANTÍA. ADVERTENCIA: LEASE ESTE

INSTRUCTIVO ANTES DE USAR EL PRODUCTO.

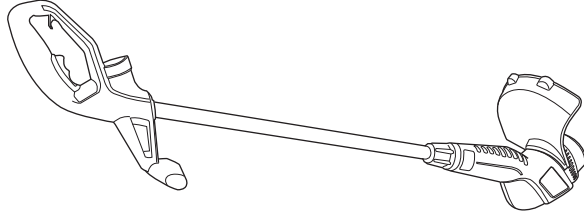

Date Code:

SAFETY GUIDELINES - DEFINITIONS

It is important for you to read and understand this manual. The information it contains relates to protecting YOUR SAFETY and PREVENTING PROBLEMS. The symbols below are used to help you recognize this information.

⚠ DANGER: Indicates an imminently hazardous situation which, if not avoided, will result in death or serious injury.

⚠ WARNING: Indicates a potentially hazardous situation which, if not avoided, could result in death or serious injury.

⚠ CAUTION: Indicates a potentially hazardous situation which, if not avoided, may result in minor or moderate injury.

⚠ NOTICE: Used without the safety alert symbol indicates a potentially hazardous situation which, if not avoided, may result in property damage.

⚠ WARNING: IMPORTANT SAFETY WARNINGS AND INSTRUCTIONS

⚠ WARNING: When using gardening appliances, basic safety precautions should always be followed to reduce risk of fire, electric shock, and personal injury, including the following.

⚠ WARNING: Some dust created by this product contains chemicals known to the State of California to cause cancer, birth defects or other reproductive harm. Some examples of these chemicals are:

- compounds in fertilizers
- compounds in insecticides, herbicides and pesticides
- arsenic and chromium from chemically treated lumber

To reduce your exposure to these chemicals, wear approved safety equipment such as dust masks that are specially designed to filter out microscopic particles.

⚠ WARNING: Wear appropriate personal hearing protection during use. Under some conditions and duration of use, noise from this product may contribute to hearing loss.

READ ALL INSTRUCTIONS

- Before any use, be sure everyone using this garden appliance reads and understands all safety instructions and other information contained in this manual.
- Save these instructions and review frequently prior to use and in instructing others.

⚠ GENERAL SAFETY WARNINGS AND INSTRUCTIONS FOR ALL APPLIANCES

- **AVOID DANGEROUS ENVIRONMENT.** Don't use appliances in damp or wet locations. Don't use appliances in the rain.
- **KEEP CHILDREN AWAY.** All visitors should be kept at a distance from work area.
- **STORE IDLE APPLIANCES INDOORS.** When not in use, appliances should be stored indoors in dry, and high or locked-up place – out of reach of children.
- **DON'T FORCE APPLIANCE.** It will do the job better and with less likelihood of a risk of injury at the rate for which it was designed.
- **USE RIGHT APPLIANCE.** Do not use the appliance for any job except that for which it is intended.
- **DRESS PROPERLY.** Do not wear loose clothing or jewelry. They can be caught in moving parts. Rubber gloves and substantial, non-skid footwear are recommended when working outdoors. Wear protective hair covering to contain long hair.
- **USE SAFETY GLASSES AND OTHER SAFETY EQUIPMENT.** Use safety goggles or safety glasses with side shields, complying with applicable safety standards and, when needed, a face shield. Also use face or dust mask if operation is dusty. This applies to all

persons in the work area. Also use a hard hat, hearing protection, gloves, safety shoes and dust collection systems when specified or required. Safety glasses or the like are available at extra cost at your local dealer or Black & Decker Service Center.

- **DON'T ABUSE CORD.** Never carry appliance by cord or yank it to disconnect from receptacle. Keep cord from heat, oil, and sharp edges.
- **DON'T OVERREACH.** Keep proper footing and balance at all times.
- **MAINTAIN APPLIANCE WITH CARE.** Keep cutting edge sharp and clean for best performance and to reduce the risk of injury. Follow instructions for lubricating and changing accessories. Inspect appliance cord periodically and if damaged, have it repaired by authorized service facility. Inspect extension cords periodically and replace if damaged. Keep handles dry, clean, and free from oil and grease.
- **DISCONNECT APPLIANCES.** Disconnect the appliance from the power supply when not in use, before servicing, and when changing accessories such as blades and the like.
- **AVOID UNINTENTIONAL STARTING.** Don't carry plugged-in appliance with finger on switch. Be sure switch is off when plugging in.
- **GROUND FAULT CIRCUIT INTERRUPTER (GFCI)** protection should be provided on the circuits or outlets to be used for the gardening appliance. Receptacles are available having built in GFCI protection and may be used for this measure of safety.
- **STAY ALERT.** Watch what you are doing. Use common sense. Do not operate appliance when you are tired.
- **CHECK DAMAGED PARTS.** Before further use of the appliance, a guard or other part that is damaged should be carefully checked to determine that it will operate properly and perform its intended function. Check for alignment of moving parts, binding of moving parts, breakage of parts, mounting and any other conditions that may affect its operation. A guard or other part that is damaged should be properly repaired or replaced by an authorized service center unless otherwise indicated elsewhere in this manual.
- **USE OF ACCESSORIES AND ATTACHMENTS.** The use of any

accessory or attachment not recommended for use with this appliance could be hazardous. Note: Refer to the accessory section of this manual for further details.

- **EXTENSION CORDS.** Make sure your extension cord is in good condition. When using an extension cord, be sure to use one heavy enough to carry the current your product will draw. An undersized extension cord will cause a drop in line voltage resulting in loss of power and overheating. The table below shows the correct size to use depending on cord length and nameplate ampere rating. If in doubt, use the next heavier gauge. The smaller the gauge number, the heavier the cord. To reduce the risk of disconnection of the appliance from the extension cord during operation, use the extension cord retainer described in this manual.

Minimum Gauge for Cord Sets		
Volts	Total Length of Cord in Feet	
120V	0-25 (0-7,6m)	26-50 (7,6-15,2m) (15,2-30,4m) (30,4-45,7m)
Ampere Rating	American Wire Gauge	
More Than	Not more Than	
0 - 6	18	16
6 - 10	18	16
10 - 12	16	14
12 - 16	14	12
		Not Recommended

- **WARNING: OUTDOOR USE EXTENSION CORDS** To reduce the risk of electric shock, use only with an extension cord intended for outdoor use, such as an extension cord of type SW-A, SOW-A, STW-A, STOW-A, SJW-A, SJOW-A, SJTW-A, or SJTOW-A.
- **REPAIRS AND SERVICE.** Repairs, maintenance and any adjustments not specified in this manual should be performed by Black & Decker authorized service centers or other qualified service organizations, always using identical replacement parts.

⚠️ IMPORTANT WARNINGS FOR STRING TRIMMERS

1. Use the proper size and type of cutting line. Do not use metal wire, rope or the like. Do not use cutting line heavier than that recommended by the manufacturer. See the accessory section of this manual for more detailed information about the proper cutting line to use.
2. Keep the cutting line trimmed to the proper length (done automatically by the appliance). Make sure that the guard is firmly in place, in working order and positioned between yourself and the cutting line.
3. Wear long pants and substantial footwear to protect yourself from injury caused by flying debris. This is especially important when edging with the appliance.

⚠️ SAFETY WARNINGS AND INSTRUCTIONS: POLARIZED PLUGS

To reduce the risk of electric shock, this equipment has a polarized plug (one blade is wider than the other). This equipment must be used with a suitable polarized 2 wire or 3 wire extension cord. Polarized connections will fit together only one way. Make sure that the receptacle end of the extension cord has large and small blade slot widths. If the plug does not fit fully into the extension cord, reverse the plug. If it still does not fit, obtain a suitable extension cord. If the extension cord does not fit fully into the outlet, contact a qualified electrician to install the proper outlet. Do not change the tool plug or extension cord in any way.

SAVE THESE INSTRUCTIONS

ASSEMBLY INSTRUCTIONS ATTACHING THE GUARD, HANDLE AND EDGE GUIDE TO THE TRIMMER/EDGER

- ⚠️ WARNING:** The guard and handle must always be on the tool to protect the user. **NEVER OPERATE TOOL WITHOUT GUARD AND HANDLE FIRMLY IN PLACE.** Unplug the tool before attempting any of the following assembly steps.
1. Locate the edge guide and spread it apart as shown in **figure 1**.
 2. Attach the edge guide to the housing by locating the two ends into the holes in the housing.

3. See **figure 1A** for edge guide assembled on the trimmer.

DO NOT INSERT THE ENDS OF THE EDGE GUIDE INTO THE FAN HOLES AS SHOWN IN FIGURE 1B.

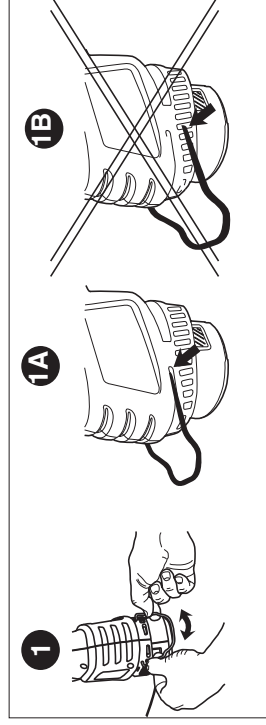

The handle is shipped with the screw partially threaded in to prevent loss.

To attach the handle:

1. Remove the screw.
2. Slide the handle onto the handle housing as shown in **figure 2**.
3. Thread the screw back into the hole and tighten securely with a screwdriver.

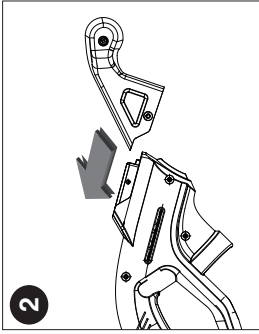

- Remove the guard attachment screw from the guard. Slip the guard onto the trimmer housing and lineup the screw hole in the guard with the screw hole in the housing (**figure 3**).

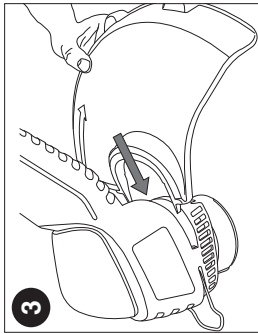

- Insert the guard attachment screw to secure the guard in place as shown in **figure 4**.

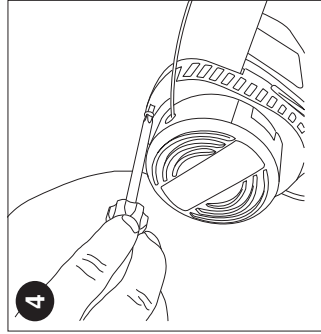

- Attach extension cord to cord retainer as shown in **figures 5 & 6**.

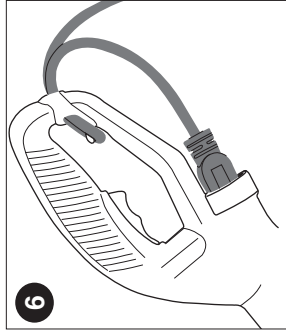
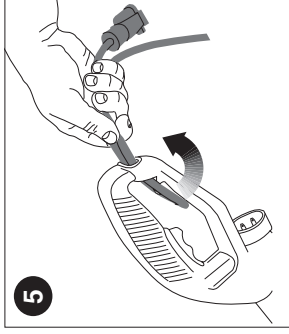

OPERATING INSTRUCTIONS FOR CATALOG # ST4500 BUMP FEED TRIMMER LINE FEED

Your trimmer uses .065 in. (1.65 mm) diameter, **ROUND** nylon line to cut grass and weeds quickly and easily. Cutting line will wear faster and require more feeding if the cutting or edging is done along sidewalks or other abrasive surfaces or heavier weeds are being cut. As you use the trimmer, the string will get shorter due to wear. Gently bump the unit on the ground and the line will feed.

⚠ CAUTION: ALWAYS USE EYE PROTECTION.

⚠ CAUTION: Inspect area to be trimmed and remove any wire, cord, or string-like objects which could become entangled in the rotating line or spool. Be particularly careful to avoid any wire which might be bent outwardly into the path of the tool, such as barbs at the base of a chain link fence.

1. Angle unit as shown in **figure 7**.

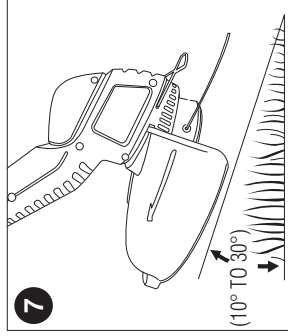

2. Slowly swing trimmer side-to-side as shown in **figure 8**.

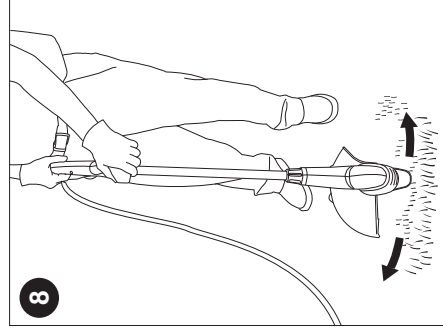

3. To convert for maintenance edging, turn off the tool. Holding the trimmer (as shown in **figure 9**) with one hand by the auxiliary handle, grasp the trimmer head collar, push in direction of arrow and rotate the trimmer head clockwise (when viewed from the switch end) until it stops, (half turn), release your hand. The tool is locked in the edger position.

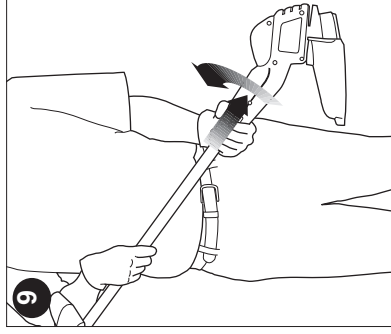

4. To operate as a maintenance edger, position trimmer above sidewalk as shown in **figure 10**.
5. Return to trimming position by turning the tool off, pushing in direction of arrow and rotating the trimmer head counter clockwise until it stops.

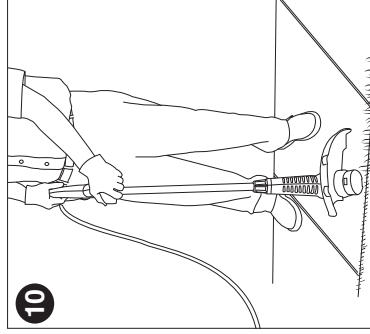

RELOADING LINE ST4500
USE ONLY .065 in. (1.65mm) DIAMETER NYLON
MONOFILAMENT LINE. Heavier line will overload the motor and cause overheating. This line is available at your local dealer or authorized service center.

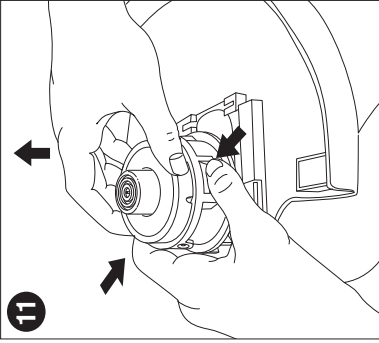

1. Unplug extension cord at trimmer.
2. Remove the bump cap by pulling up while depressing the two release tabs on the sides of the hub at the points shown in **figure 11**.

NOTE: It may be necessary to pull up on the cap while depressing the release tabs one side at a time.

3. Remove any broken cutting line, wrap the remaining line tight and reinsert spool into hub as follows.

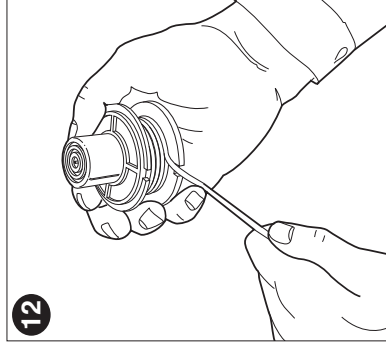

- a. Wind the line tight enough so that it is all below the edges of the flanges on the spool. If it extends past the flanges, it won't fit into the hub.
- b. Place the loose end of the cutting line through the gap in the spool flange as shown in **figure 12**. (Either gap will do but try to leave yourself about 3 or 4 inches of line to work with.)

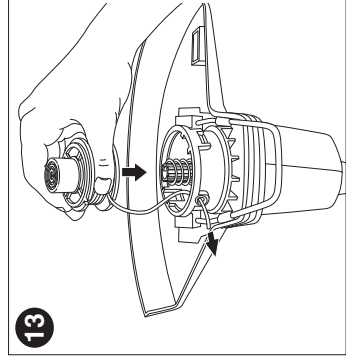

- c. Holding the line in the gap, insert the end through the eyelet in the hub and slip the spool into the hub, as shown in **figure 13**.

Make sure the spring is still in place in the hub. If the spool does not slip into the hub easily, press gently and pull straight out on the cutting line that protrudes through the eyelet.

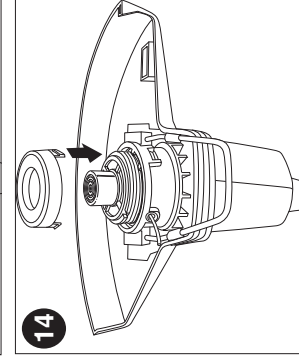

4. Once the spool drops into the hub, align the release tabs on the shroud with the slots in the hub as shown in **figure 14** and press the shroud into place. Be sure that both release tabs snap into place.

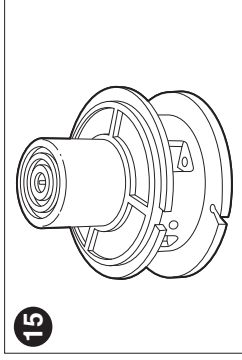

5. To replace the line on a spool, follow the steps below
 - a. Locate, on the empty spool, one of the two small holes shown in **figure 15**.

- b. Insert the end of the line no more than 1/8 in. into the hole and begin winding the line around the spool (**figure 16**).

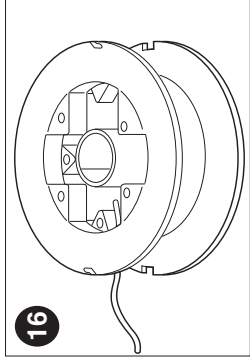

- Be sure to wind the line in the direction of the arrow in **figure 17**. Do not overfill spool. The spool holds 20 feet (6 m) of line.
- c. Perform steps 3 and 4 above.

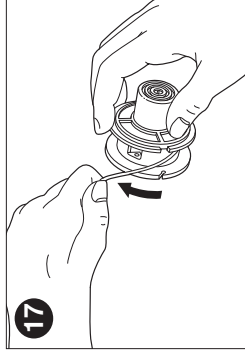

Problem

- Unit will not start.

Troubleshooting

Possible Cause

- Cord not plugged in.
- Circuit fuse is blown.
- Circuit breaker is tripped.
- Cord or switch is damaged.

Possible Solution

- Plug in cord.
- Replace circuit fuse.
- Reset circuit breaker.
- Have cord or switch replaced at Black & Decker Service Center or Authorized Servicer.

For assistance with your product, visit our website www.blackanddecker.com for the location of the service center nearest you or call the BLACK & DECKER help line at 1-800-544-6986.

MAINTENANCE

CLEANING

Use only mild soap and damp cloth to clean the tool. Never let any liquid get inside the tool; never immerse any part of the tool into a liquid.

IMPORTANT: To assure product SAFETY and RELIABILITY, repairs, maintenance and adjustment should be performed by Black & Decker service centers or other qualified service organizations, always using identical replacement parts.

ACCESSORIES

Recommended accessories for use with your tool are available from your local dealer or authorized service center. If you need assistance regarding accessories, please call: **1-800-544-6986**.

WARNING: The use of any accessory not recommended for use with this tool could be hazardous.

SERVICE INFORMATION

Black & Decker offers a full network of company-owned and authorized service locations throughout North America. All Black & Decker Service Centers are staffed with trained personnel to provide customers with efficient and reliable power tool service. Whether you need technical advice, repair, or genuine factory replacement parts, contact the Black & Decker location nearest you. To find your local service location, refer to the yellow page directory under "Tools—Electric" or call: **1-800-544-6986**.

FULL TWO YEAR WARRANTY

Black & Decker (U.S.) Inc. warrants this product for two years against any defects in material or workmanship. The defective product will be replaced or repaired at no charge in either of two ways. The first, which will result in exchanges only, is to return the product to the retailer from whom it was purchased (provided that the store is a participating retailer). Returns should be made within the time period of the retailer's policy for exchanges (usually 30 to 90 days after the sale). Proof of purchase may be required. Please check with the retailer for their specific return policy regarding returns that are beyond the time set for exchanges.

The second option is to take or send the product (prepaid) to a Black & Decker owned or authorized Service Center for repair or replacement at our option. Proof of purchase may be required. Black & Decker owned and authorized Service Centers are listed under

"Tools-Electric" in the yellow pages of the phone directory and available on our website www.blackanddecker.com.

This warranty does not apply to accessories. This warranty gives you specific legal rights and you may have other rights which vary from state to state. Should you have any questions, contact the manager of your nearest Black & Decker Service Center.

Free warning label replacement: If your warning labels become illegible or are missing, call **1-800-544-6986** for a free replacement. **LATIN AMERICA:** This warranty does not apply to products sold in Latin America. For products sold in Latin America, check country specific warranty information contained in the packaging, call the local company or see the website for warranty information.



Imported by
Black & Decker (U.S.) Inc.,
701 E. Joppa Rd.
Towson, MD 21286 U.S.A.



See 'Tools-Electric'
– Yellow Pages –
for Service & Sales